

## Instructions

# Flowerpot VP4 Verner Panton 1968



---

Please read these instructions carefully and retain them for future reference to ensure the product is used correctly. For your own safety, please study each step of this instruction manual first. &Tradition is not responsible for any faults or damage caused by not following these instructions correctly. Do not modify this product in any way. If you have any questions or comments, please do not hesitate to contact us by mail on: [info@andtradition.com](mailto:info@andtradition.com)

&Tradition®

# Flowerpot VP4

## Verner Panton

### 1968

---

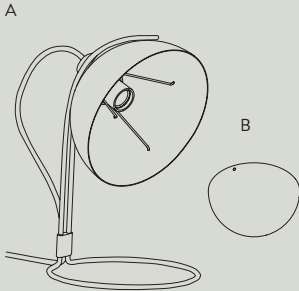

#### Safety precautions

- Dispose the packaging and do not allow children to play with it.
- The lamp is only intended for interior use.
- Do not place the cable within reach of small children or anywhere there is a risk of it becoming a trip hazard.
- If the external cable or cord of the lamp is damaged, it must be replaced by the manufacturer or a similarly qualified person to avoid any potential hazards.
- Consult a professionally qualified electrician if in any doubt.
- Keep the product well out of reach of children.

#### Contents

- A** Lamp
- B** Bottom lamp shade

#### Tools needed

- Bulb type E27

#### Cleaning instructions

- Wipe surface of the shade with a dry cloth.
- Do not use any abrasive cleaning tools such as steel wool, scouring sponges or stiff brushes.
- Never use strong cleaning agents such as white spirit, turpentine, household glass cleaner or cellulose thinners.

10/24

For indoor use only  
E27 Maximum 40W  
Bulb not included



&Tradition®

Please follow steps 1 to 3 to assemble the product.

**Step 1 / 3**

---

Install the light bulb.

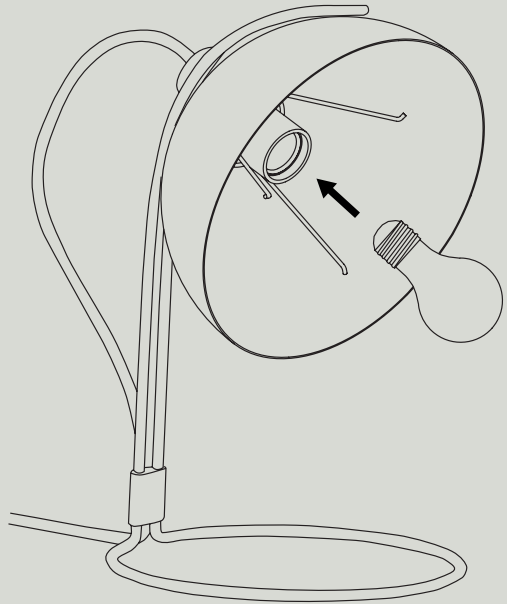

**Step 2 / 3**

---

Mount the bottom lamp shade onto the three pronged arm inside the shade.

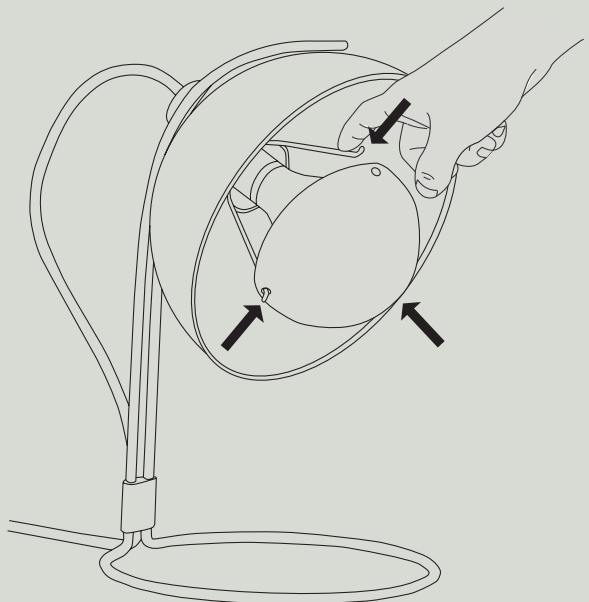

### Step 3 / 3

---

To adjust the angle of the light, grip the top of the shade while supporting the base with the other hand. Slide the top of the shade up or down to set the desired angle.

It is best to set the angle before turning the lamp on, as the shade gets hot when the lamp is in use for longer periods of time.

